

JVC

SERVICE MANUAL

DIGITAL STILL CAMERA

GC-X1A-S

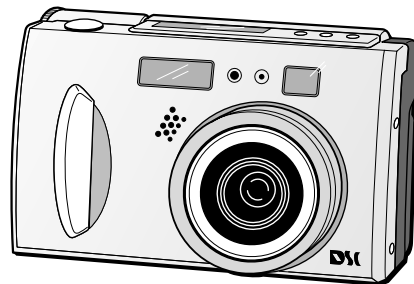

DSC
DIGITAL
STILL CAMERA

Regarding service information other than these sections, refer to the GC-X1E-S service manual (No.86572). Also, be sure to note important safety precautions provided in the service manual.

SPECIFICATIONS

Power source	: DC 5 V \equiv	Self timer	: 1 second, 8 seconds
Power consumption	: 4.0 W (when the LCD screen is off) 5.6 W (when the LCD screen is on)	Photo quality	: 3 modes (STANDARD/FINE/NO COMP.)
Dimensions	: 101 (W) mm x 67 (H) mm x 59 (D) mm (except protruding parts)	Number of storable photos (with an 8MB Memory card, STANDARD/FINE/NO COMP.)	: 2032 x 1536: approx. 10/8/0 1024 x 768: approx. 43/32/3 640 x 480: approx. 87/65/8
Weight	: Approx. 290 g (without a Memory card and battery)	Battery	: Lithium ion battery
Operating temperature	: 0°C to 40°C	Printer connector	: Output for optional printer
Relative humidity	: 35% to 80%	VIDEO output connector	: Two-pole plug, 3.5 mm diameter (PAL)
Storage temperature	: -20°C to 50°C	Digital output connector	: Mini-USB connector
LCD screen	: 2.0 inch, polysilicon TFT (200,000 pixels)		
Storage media	: SmartMedia™ 3.3V (up to 64MB)		
CCD	: 3.34 million pixels (3.24 million valid pixels), 1/1.8" square pixels, primary color filter, interlace scan CCD		
Focal distance	: 7.5 mm to 17.5 mm (equivalent to 37mm to 86 mm on a 35 mm still camera)	AC Power Adapter/Charger AA-V37	
Lens	: 2.3X optical zoom lens	Power requirement	
Video	: 160 pixels x 120 pixels, 20 seconds, JVC original format	U.S.A. and Canada	: AC 120 V \sim , 60 Hz
Recording format	: Exif Ver. 2.1 (DCF compliant), TIFF (Uncompressed), DPOF-compatible	Other countries	: AC 110 V – 240 V \sim , 50 Hz/60 Hz
Sensitivity	: 80/160/320 (ISO compliant)	Power consumption	: 23 W
Iris value (F value)	: F2.8/3.8, 5.6, 8, 11	Output	
Exposure control	: Program AE, iris priority AE	Charge	: DC 3.6 V \equiv , 0.77 A
Exposure compensation	: +/-2EV (0.5EV steps)	Camera	: DC 5.0 V \equiv , 1.5 A
Minimum subject distance	: Approx. 2 cm to 50 cm (in Macro mode)	Operating temperature	: 0°C to 40°C [when charging: 10°C to 35°C]
Light measurement system	: Multi, spot	Dimensions	: 68 (W) mm x 38 (H) mm x 110 (D) mm
Flash	: Built-in, Auto/red-eye prevention/forced/disabled	Weight	: Approx. 230 g (without a DC cord)
Recommended distance for flash	: Approx. 2.5 m		
Shutter speed	: Auto (Program AE: 1/8 seconds – 1/750 seconds, Iris priority AE: 1/4 seconds – 1/750 seconds)		
White balance	: Auto/Manual (☀, ☁, ☁, MWB, ☾)		
Focus	: Auto/Manual		

E. & O. E. Design and specifications subject to change without notice.

TABLE OF CONTENTS

4. PARTS LIST

4.1 PACKING AND ACCESSORY ASSEMBLY <M1> 4-1

The following table indicate different parts number between models GC-X1E-S and GC-X1A-S.

PACKING AND ACCESSORY ASSEMBLY <M1>

REF △ NO.	MODEL ITEM	GC-X1E-S	GC-X1A-S
1	PACKING CASE	LY31465-003A	LY31465-012A
10	GUARANTY CARD	BT-54008-2	—
21	POLY BAG	QPA02003006	YQM30061-3
△ 22	AC POWER ADAPTER	LY20545-003C	LY20545-007A
23	BATTERY PACK	*LY31583-002A	←
28	REGIST CARD	—	YU30878
△ 32	INST. BOOK (GE)	LYT0544-002B	—
△ 33	INST. BOOK (FR)	LYT0544-003B	—
36	SHEET (ATT)	*LYT0544-015A	—
△ 37	INST. BOOK (RU)	—	LYT0544-012A
△ 38	INST. BOOK (AR)	—	LYT0544-013A
39	SHEET (CON PLUG)	—	LYT0609-001A
△ 40	CONVERSION PLUG	—	PEMC1012

MAIN BOARD ASSEMBLY <01>

REF △ NO.	MODEL ITEM	GC-X1E-S	GC-X1A-S
PW1	MAIN BOARD ASSEMBLY	*YB10282E-06	←

Note : Mark — is not used.

Note : Mark ← is same as left.

Note : Mark * reference model was also change.

SECTION 4 PARTS LIST

SAFETY PRECAUTION

Parts identified by the \triangle symbol are critical for safety. Replace only with specified part numbers.

4.1 PACKING AND ACCESSORY ASSEMBLY <M1>

The instruction manual to be provided with this product will differ according to the destination.

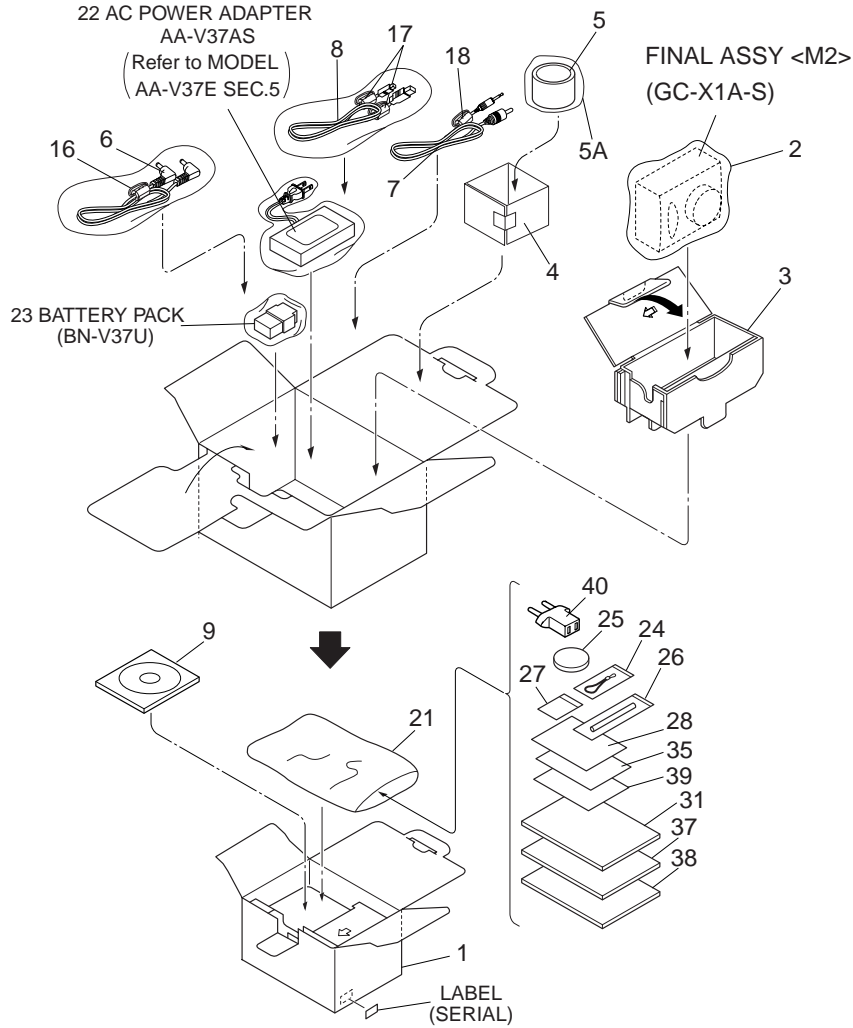

\triangle REF No. PART No. PART NAME, DESCRIPTION

PACKING AND ACCESSORY ASSEMBLY <M1>

# \triangle REF No.	PART No.	PART NAME, DESCRIPTION
1	LY31465-012A	PACKING CASE
2	LY30023-016A	POLY BAG
3	LY31466-001A	CUSHION
4	LY42548-001A	SHEET
5	LY31822-001A	HOOD (OP)
5A	QPA01001505	POLY BAG
6	PEAC0449	DC PLUG CORD
7	PEAC0496	VIDEO CABLE
8	QAM0252-001	USB CABLE
9	LY31074-010A	CD ROM ASSEMBLY
16	QQR0491-002	CORE FILTER
17	QQR0491-001	CORE FILTER

\triangle REF No. PART No. PART NAME, DESCRIPTION

18	QQR0917-001	CORE FILTER
21	YQM30061-3	POLY BAG
22	LY20545-007A	AC POWER ADAP. (AA-V37AS)
23	LY31583-002A	BATTERY PACK (BN-V37U)
24	LY30663-001A	HAND STRAP
25	LY31468-002A	LENS CAP
26	LY42313-001A	STRING
27	LY31737-001A	MEDIA CARD ASSEMBLY
28	YU30878	REGIST. CARD,
\triangle 31	LYT0544-001C	INST.BOOK (EN)
35	LYT0543-005B	SHEET (HOOD)
\triangle 37	LYT0544-012A	INST.BOOK (RU)
\triangle 38	LYT0544-013A	INST.BOOK (AR)
39	LYT0609-001A	SHEET (CON. PLUG)
\triangle 40	PEMC1012	CONVERSION PLUG



JVC

VICTOR COMPANY OF JAPAN, LIMITED
VIDEO DIVISION

S40894